

General Description

SFGMOS[®]

$R_{DS(ON)}$, low gate charge, fast switching and excellent avalanche characteristics. The cd al S_Q WR₁ BF78P.  @BF78P

Absolute Maximum Ratings at $T_j=25^{\circ}\text{C}$ unless otherwise noted

| Parameter | Symbol | Value | Unit |
|---|----------------|------------|--------------------|
| Drain source voltage | V_{DS} | 80 | V |
| Gate source voltage | V_{GS} | ± 20 | V |
| Continuous drain current ¹⁾ , $T_C=25^{\circ}\text{C}$ | I_D | 100 | A |
| Pulsed drain current ²⁾ , $T_C=25^{\circ}\text{C}$ | $I_{D, pulse}$ | 300 | A |
| Continuous diode forward current ¹⁾ , $T_C=25^{\circ}\text{C}$ | I_S | 100 | A |
| Diode pulsed current ²⁾ , $T_C=25^{\circ}\text{C}$ | $I_{S, pulse}$ | 300 | A |
| Power dissipation ³⁾ , $T_C=25^{\circ}\text{C}$ | P_D | 148 | W |
| Single pulsed avalanche energy ⁵⁾ | E_{AS} | 135 | mJ |
| Operation and storage temperature | T_{stg}, T_j | -55 to 150 | $^{\circ}\text{C}$ |

Thermal Characteristics

| Parameter | Symbol | Value | Unit |
|--|--------|-------|-----------------------------|
| Thermal resistance, junction-case | R | 0.84 | $^{\circ}\text{C}/\text{W}$ |
| Thermal resistance, junction-ambient ⁴⁾ | R | 62 | $^{\circ}\text{C}/\text{W}$ |

Electrical Characteristics at $T_j=25^{\circ}\text{C}$ unless otherwise specified

| Parameter | Symbol | Min. | Typ. | Max. | Unit | Test condition |
|----------------------------------|--------------|------|------|------|------|---|
| Drain-source breakdown voltage | BV_{DSS} | 80 | | | V | $V_{GS}=0\text{ V}, I_D=250\text{ A}$ |
| Gate threshold voltage | $V_{GS(th)}$ | 2.0 | | 4.0 | V | $V_{DS}=V_{GS}, I_D=250\text{ A}$ |
| Drain-source on-state resistance | $R_{DS(ON)}$ | | 6 | 6.5 | | $V_{GS}=10\text{ V}, I_D=12\text{ A}$ |
| Gate-source leakage current | I_{GSS} | | | 100 | nA | $V_{GS}=20\text{ V}$ |
| | | | | -100 | | $V_{GS}=-20\text{ V}$ |
| Drain-source leakage current | I_{DSS} | | | 1 | A | $V_{DS}=80\text{ V}, V_{GS}=0\text{ V}$ |
| Gate resistance | R_G | | 3.1 | | | |

Dynamic Characteristics

| Parameter | Symbol | Min. | Typ. | Max. | Unit | Test condition |
|------------------------------|--------------|------|------|------|------|--|
| Input capacitance | C_{iss} | | 4242 | | pF | $V_{GS}=0\text{ V}$, $V_{DS}=25\text{ V}$, kHz |
| Output capacitance | C_{oss} | | 1779 | | pF | |
| Reverse transfer capacitance | C_{rss} | | 84.1 | | pF | |
| Turn-on delay time | $t_{d(on)}$ | | 28 | | ns | $V_{GS}=10\text{ V}$, $V_{DS}=40\text{ V}$, R_G $I_D=50\text{ A}$ |
| Rise time | t_r | | 6.5 | | ns | |
| Turn-off delay time | $t_{d(off)}$ | | 48.5 | | ns | |
| Fall time | t_f | | 7.5 | | ns | |

Gate Charge Characteristics

| Parameter | Symbol | Min. | Typ. | Max. | Unit | Test condition |
|--------------------|----------|------|------|------|------|---|
| Total gate charge | Q_g | | 53.2 | | nC | $V_{GS}=10\text{ V}$, $V_{DS}=40\text{ V}$, $I_D=50\text{ A}$ |
| Gate-source charge | Q_{gs} | | 17.5 | | nC | |
| Gate- | | | | | | |

Electrical Characteristics Diagrams

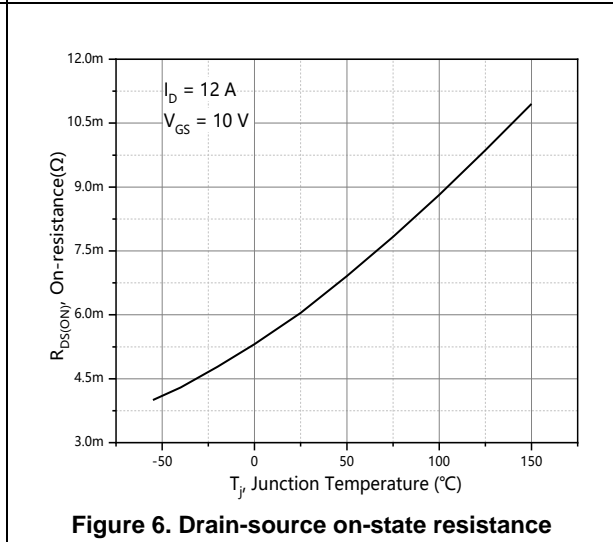
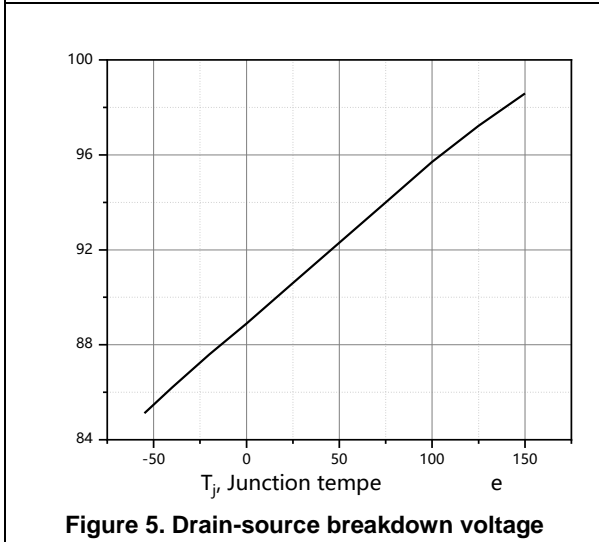
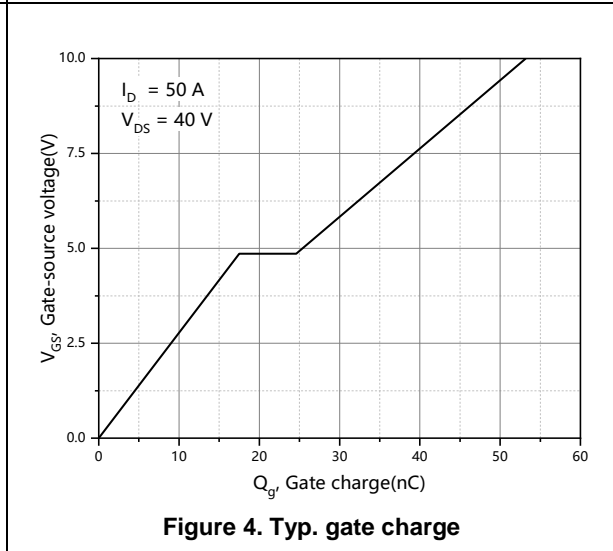
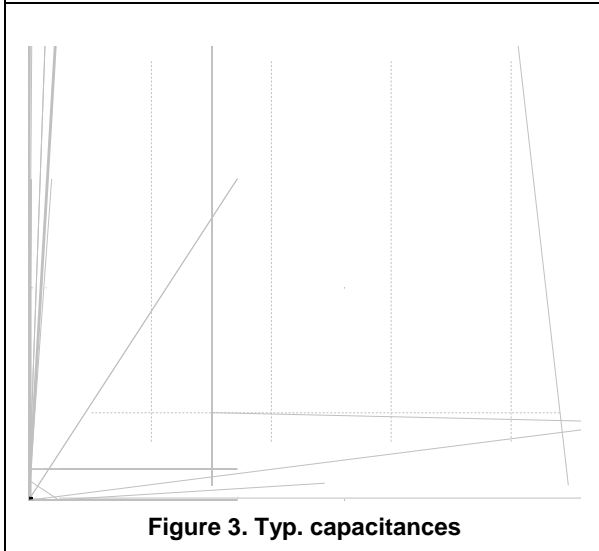
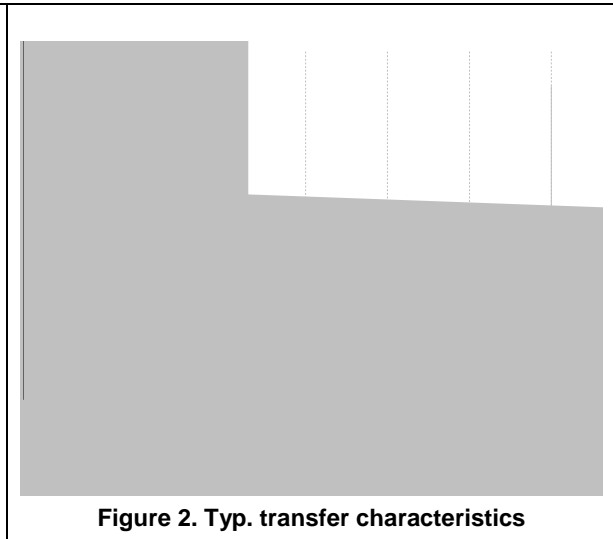
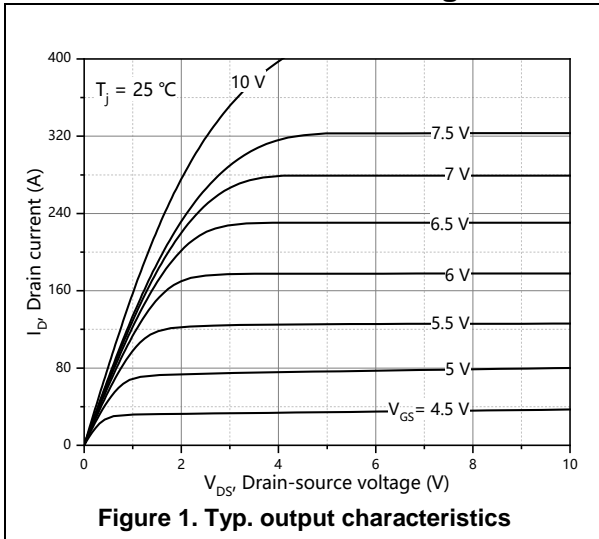

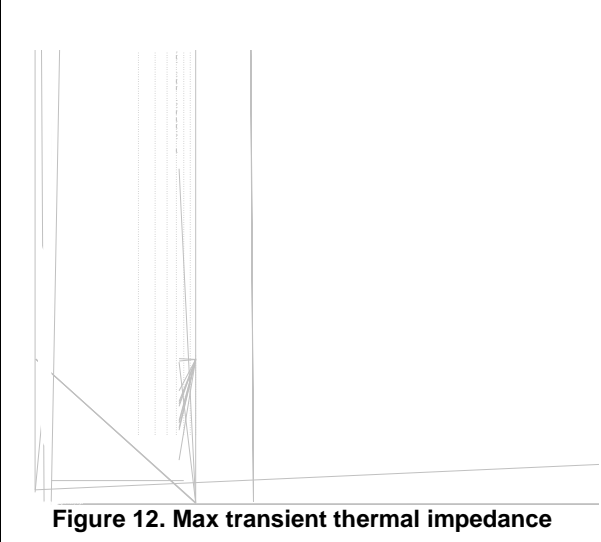
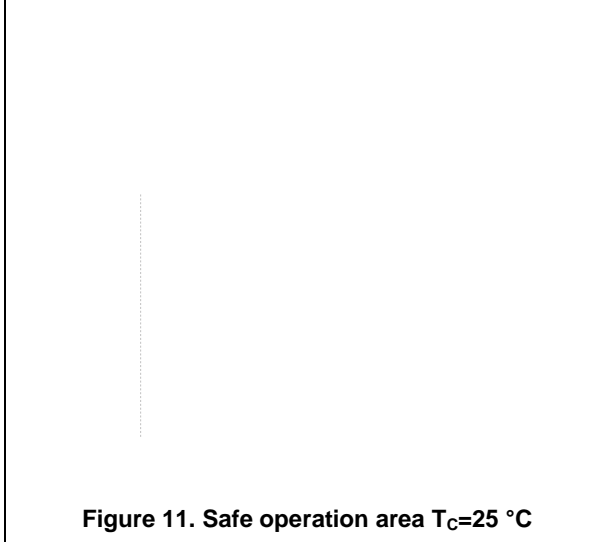
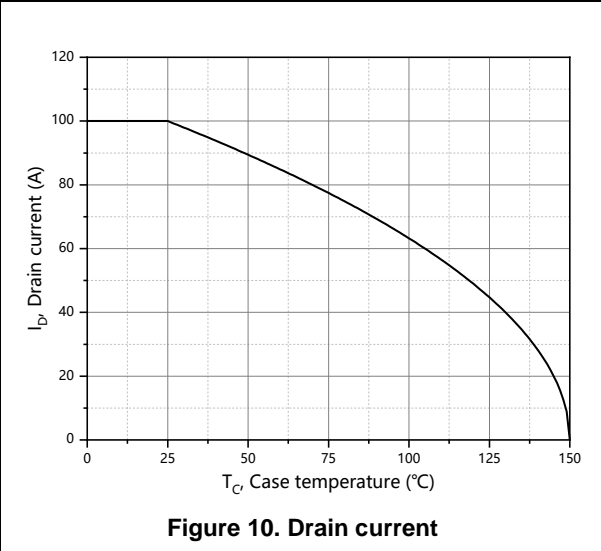
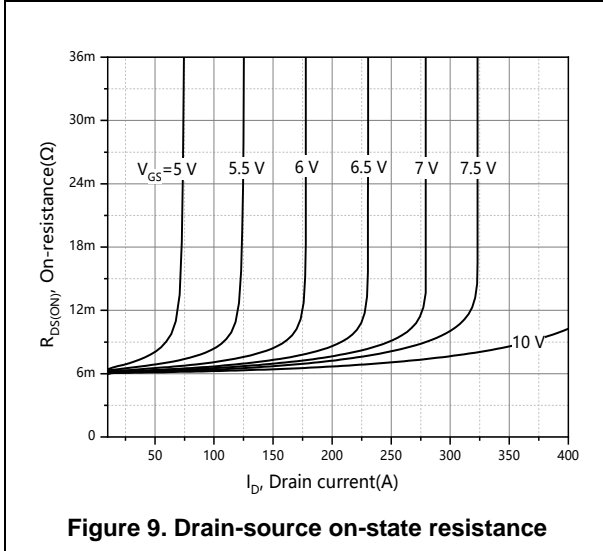
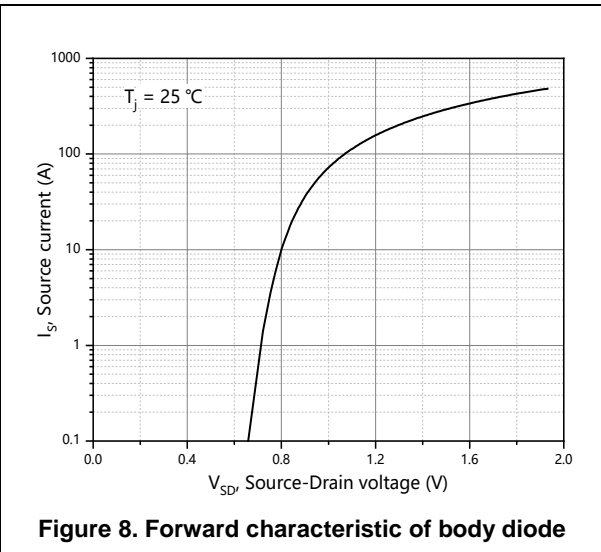
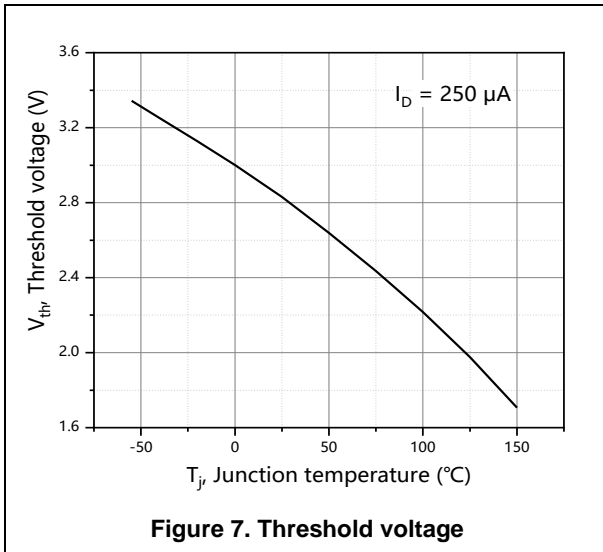

Test circuits and waveforms

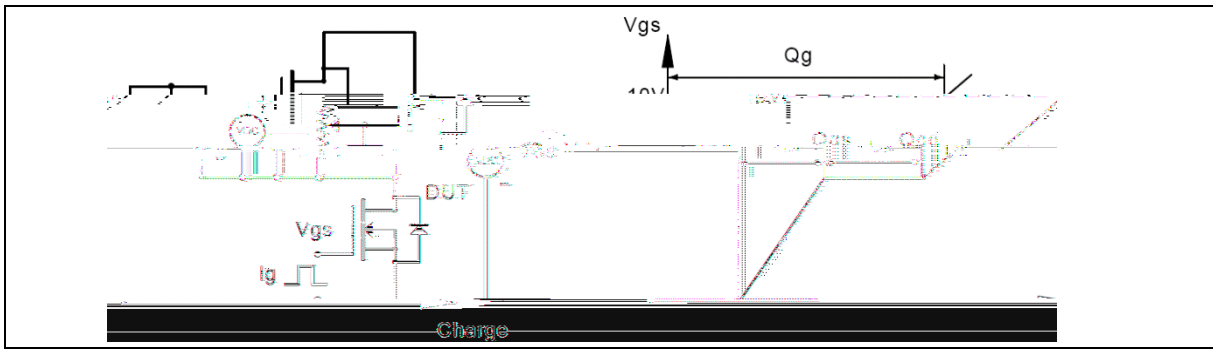

Figure 1. Gate charge test circuit & waveform

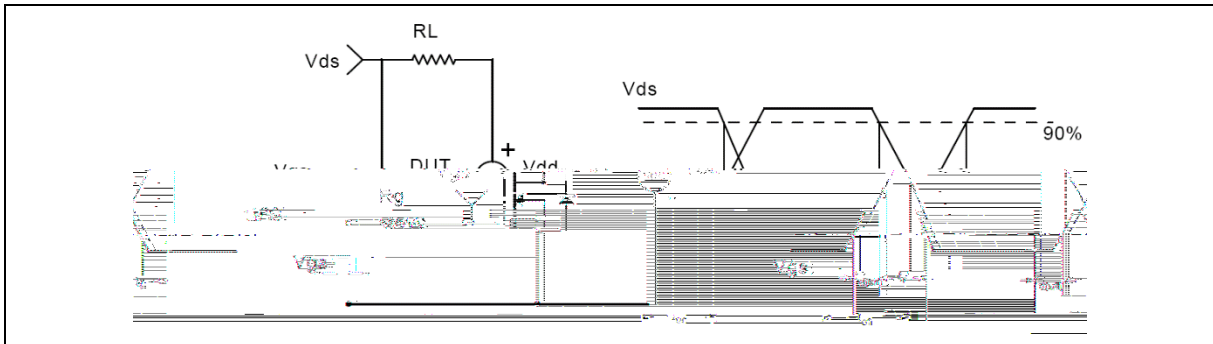

Figure 2. Switching time test circuit & waveforms

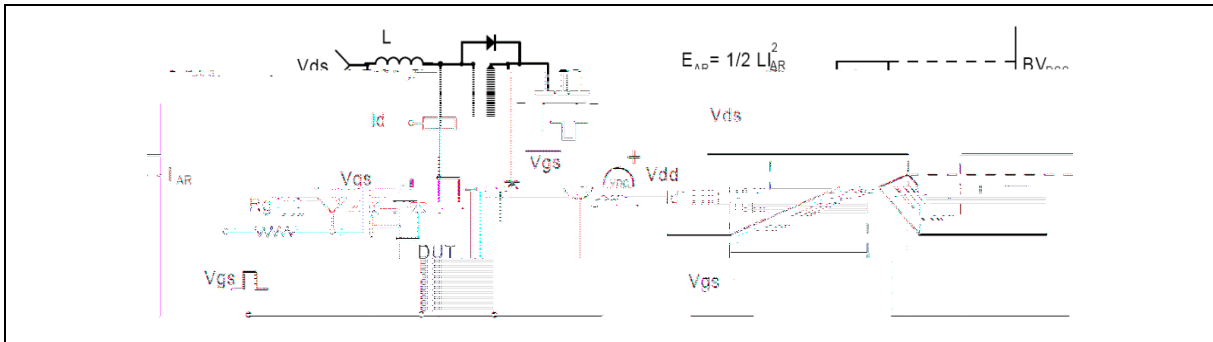

Figure 3. Unclamped inductive switching (UIS) test circuit & waveforms

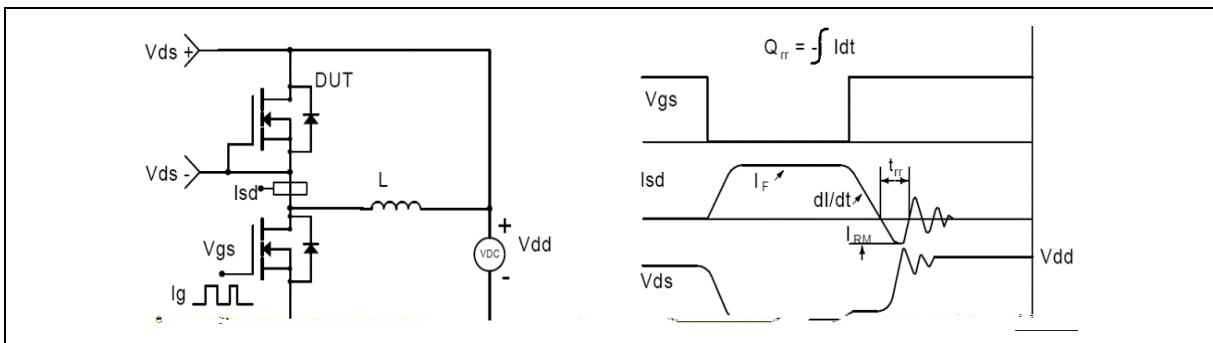
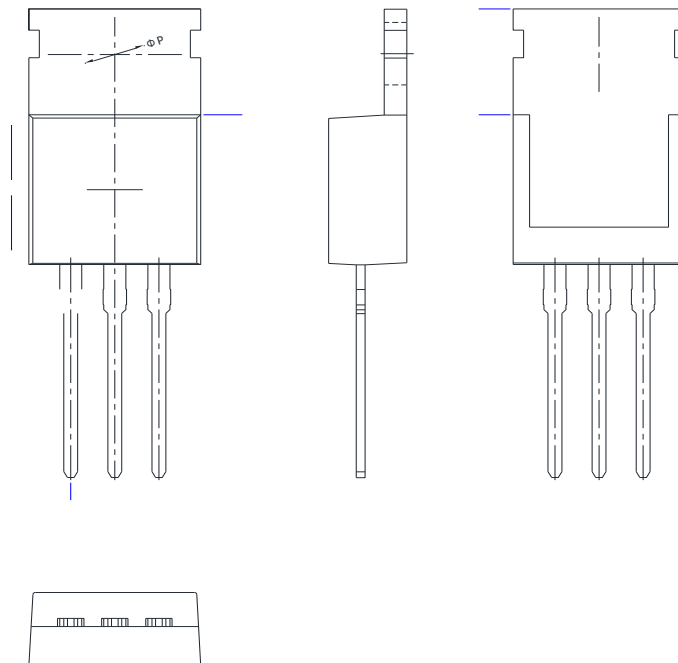

Figure 4. Diode reverse recovery test circuit & waveforms

Package Information



| Symbol | mm | | |
|--------|----------|-------|-------|
| | Min | Nom | Max |
| A | 4.40 | 4.50 | 4.60 |
| A1 | 1.27 | 1.30 | 1.33 |
| A2 | 2.30 | 2.40 | 2.50 |
| b | 0.70 | - | 0.90 |
| b1 | 1.27 | - | 1.40 |
| c | 0.45 | 0.50 | 0.60 |
| D | 15.30 | 15.70 | 16.10 |
| D1 | 9.10 | 9.20 | 9.30 |
| D2 | 13.10 | - | 13.70 |
| E | 9.70 | 9.90 | 10.20 |
| E1 | 7.80 | 8.00 | 8.20 |
| e | 2.54 BSC | | |
| e1 | 5.08 BSC | | |
| H1 | 6.30 | 6.50 | 6.70 |
| L | 12.78 | 13.08 | 13.38 |
| L1 | - | - | 3.50 |
| L2 | 4.60 REF | | |
| | 3.55 | 3.60 | 3.65 |
| Q | 2.73 | - | 2.87 |
| | 1° | 3° | 5° |

Version 1: TO220-J package outline dimension

Ordering Information

| Package Type | Units/ Tube | Tubes/ Inner Box | Units/ Inner Box | Inner Boxes/ Carton Box | Units/ Carton Box |
|--------------|-------------|------------------|------------------|-------------------------|-------------------|
| TO220-J | 50 | 20 | 1000 | 5 | 5000 |

Product Information

Product**Package****Pb Free****RoHS****Halogen Free**