



**G3S06503H**

---

% $\pm$ )

155		

---

- 
- 
- 
- 

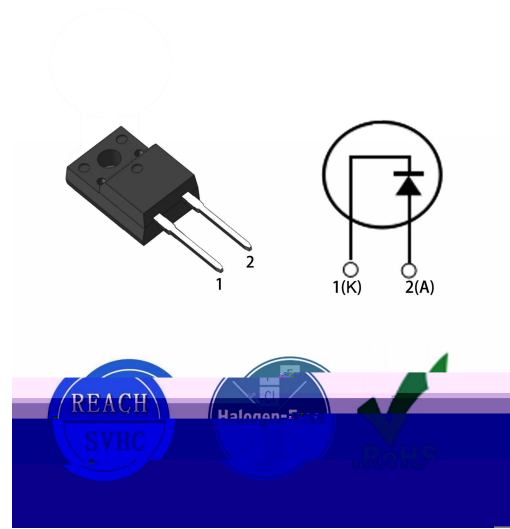

---

(SMPS)

(PFC)

- 
- 

G3S06503H	TO-220F	G3S06503H

	$V_{RRM}$		650	V
	$V_{RSM}$		650	V
	$V_{DC}$		650	V
	$I_F$	$T_C=25$ $T_C=125$ $T_C=155$	10 5.4 3	A
	$I_{FRM}$	$T_C=25$ , $tp=10ms$ Half Sine Wave $D=0.3$	20	A
	$I_{FSM}$	$T_C=25$ , $tp=10ms$ Half Sine Wave	35	A
	$P_{TOT}$	$T_C=25$	37	W
		$T_C=110$	16	W
	$T_j$		-55 to 175	
	$T_{stg}$		-55 to 175	
		M3 Screw	1	Nm
		6-32 Screw	8.8	lbf-in

	$R_{thJC}$		4.01	$\Delta W$

	$V_F$	$I_F=3A, T_j=25$	1.41	1.7	V
		$I_F=3A, T_j=175$	1.78	2	
	$I_R$	$V_R=650V, T_j=25$	0.07	50	$\mu A$
		$V_R=650V, T_j=175$	0.65	100	
	$Q_C$	$= \int$		-	nC
	$C$	$V_R=0V, T_j=25, f=1MHz$	181	220	pF
		$V_R=200V, T_j=25, f=1MHz$	22.5	25	
		$V_R=400V, T_j=25, f=1MHz$	20.5	21	

1)  $I_F=f(V_F)$   $T_j$

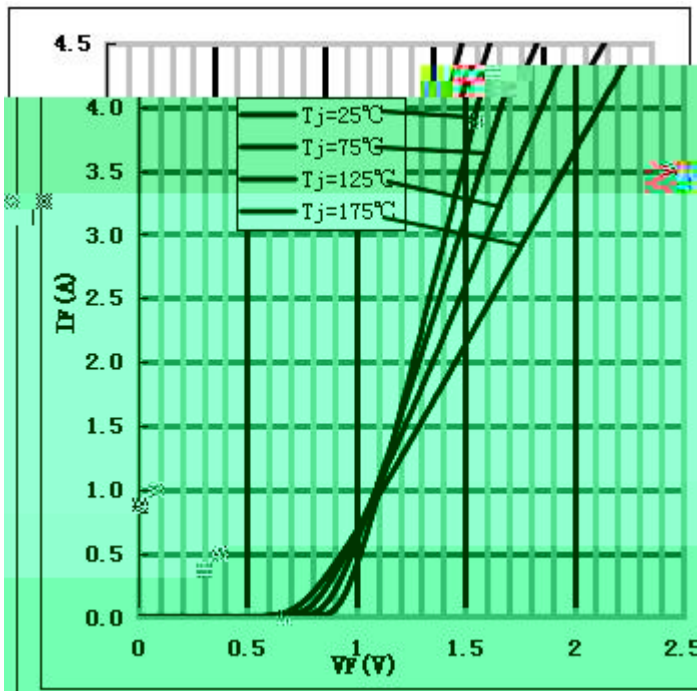

2)

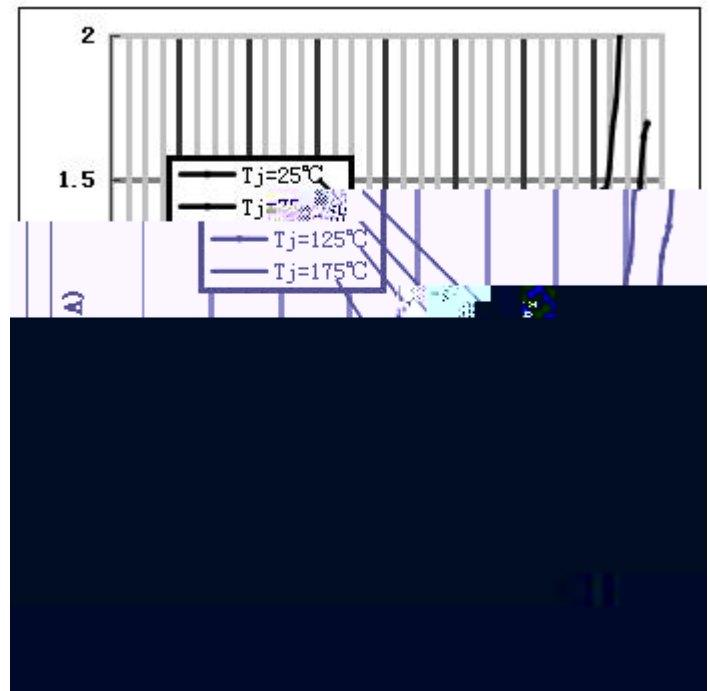

3)

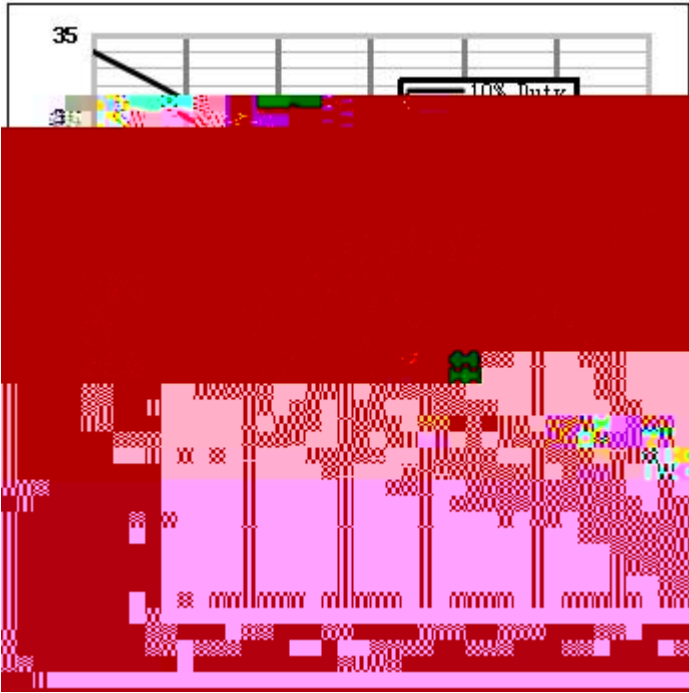

4)

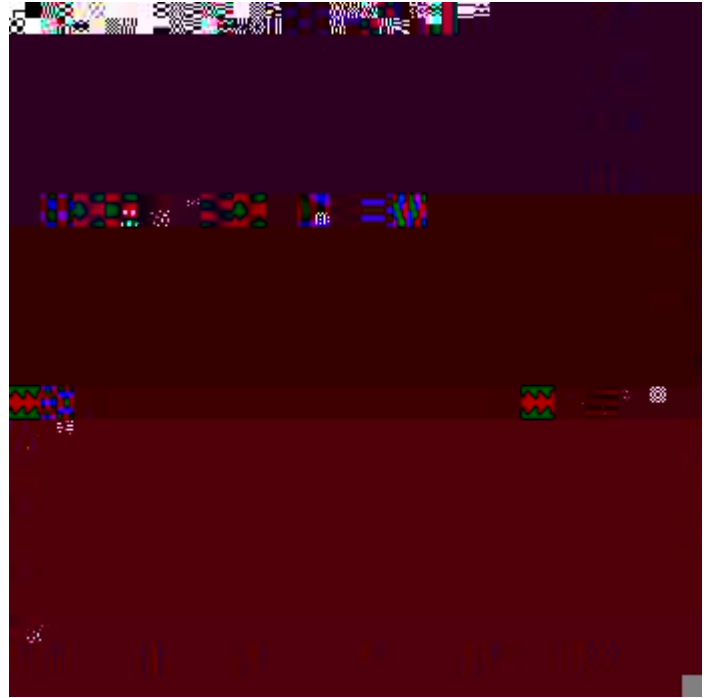

单位：mm

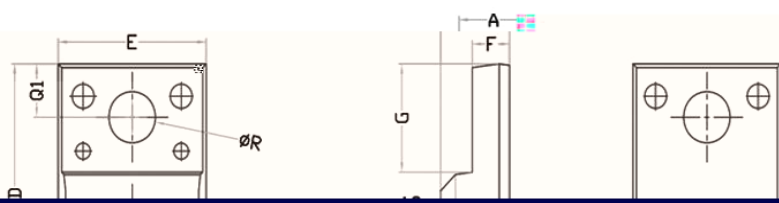

SYMBOL	DIMENSIONS		
	Min.	Nom.	Max.
A	4.60	4.70	4.80
b			

2Xb	E	10.00	10.10	10.30	2Xe
	F	2.44	2.54	2.64	

c	J1	3.13	3.23	3.33	Note

:

ISO9001 2015

2015 9 23

ISO9000

ISO 1987

ISO9001

ISO9001

ISO9001 2015

<http://www.globalpowertech.cn/CompVisualize.asp>

<https://globalpowertech.en.alibaba.com/>

<http://www.globalpowertech.cn/>

