

Features

- Low gate charge
- 100% avalanche tested
- Improved dv/dt capability
- RoHS compliant
- Halogen free package
- JEDEC Qualification

Absolute Maximum Ratings

Parameter	Symbol	TMD630Z(G)/TMU630Z(G)	Unit
Drain-Source Voltage	V_{DSS}	200	V
Gate-Source Voltage	V_{GS}	30	V
Continuous Drain Current	I_D	$T_C = 25$	A
		$T_C = 100$	A
Pulsed Drain Current ^(Note 1)	I_{DM}	36	A
Single Pulse Avalanche Energy ^(Note 2)	E_{AS}	162	

Electrical Characteristics : $T_C=25$, unless otherwise noted

- Note :
1. Repeated rating : Pulse width limited by safe operating area
 2. $L=3mH, I_{AS} = 9A, V_{DD} = 50V, R_G = 25$, Starting $T_J= 25$
 3. $I_{SD} 9A, di/dt \quad \mu s, V_{DD} \quad DS, Starting T_J= 25$
 5. Essentially Independent of Operating Temperature Typical Characteristics

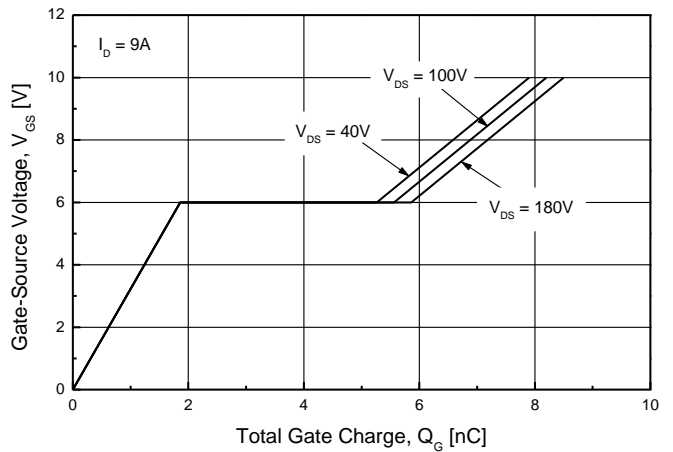
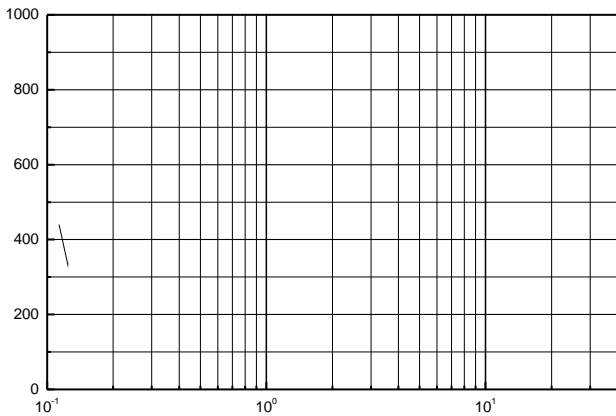
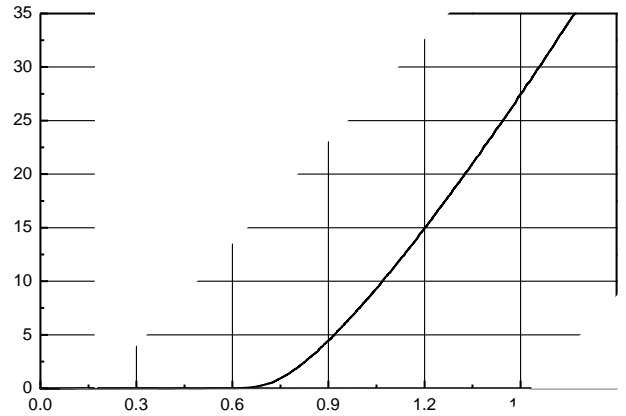
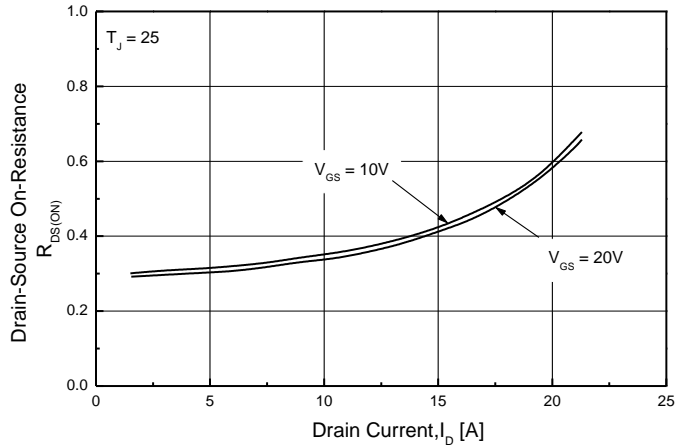
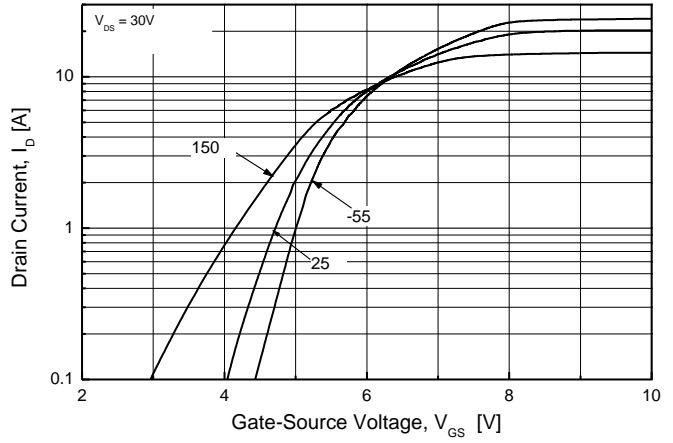
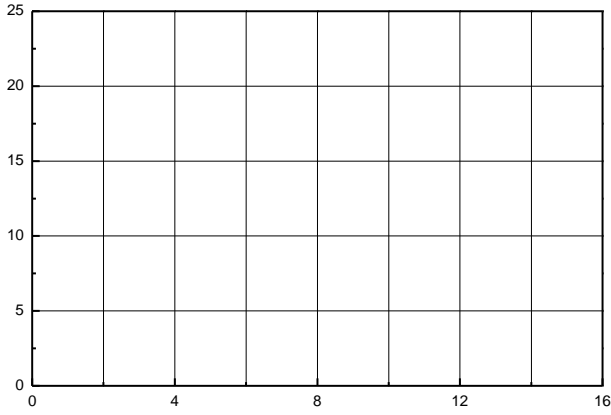

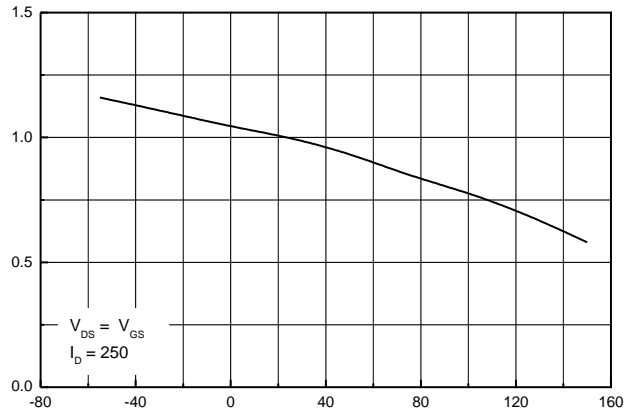
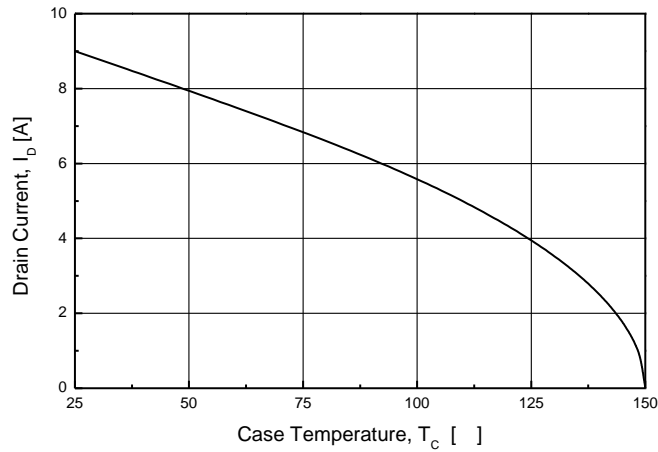
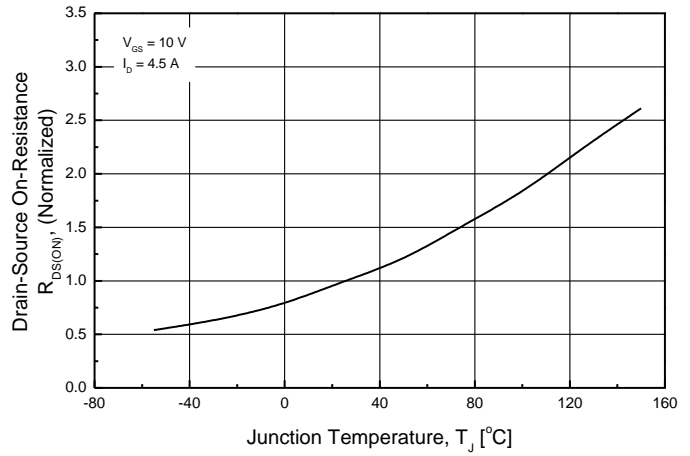
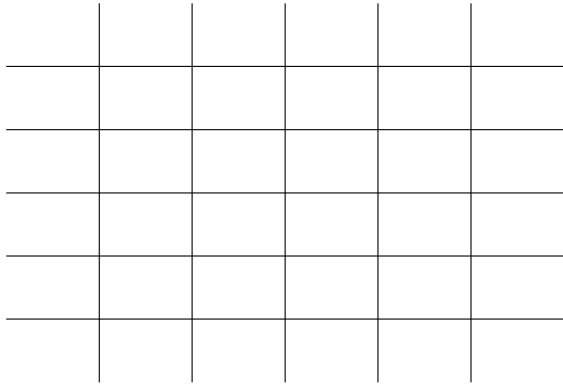

160

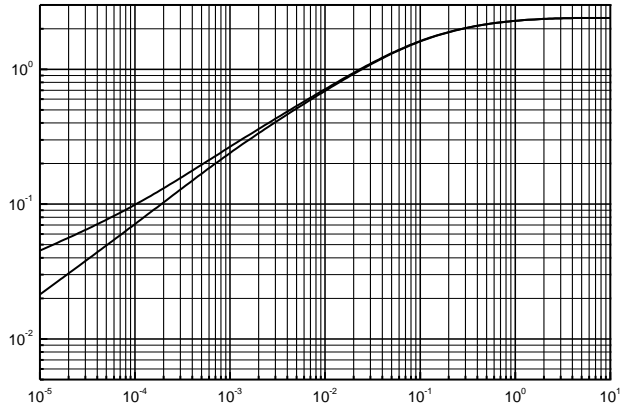
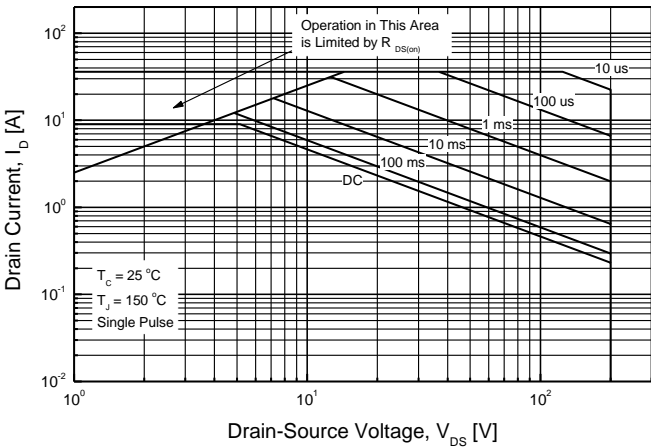

TO-252 (D-PAK) MECHANICAL DATA

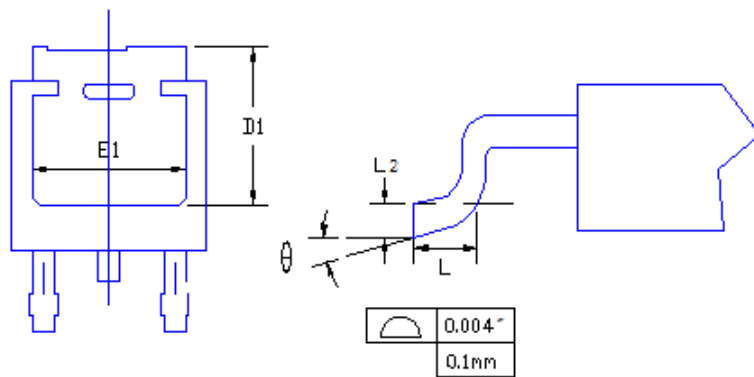
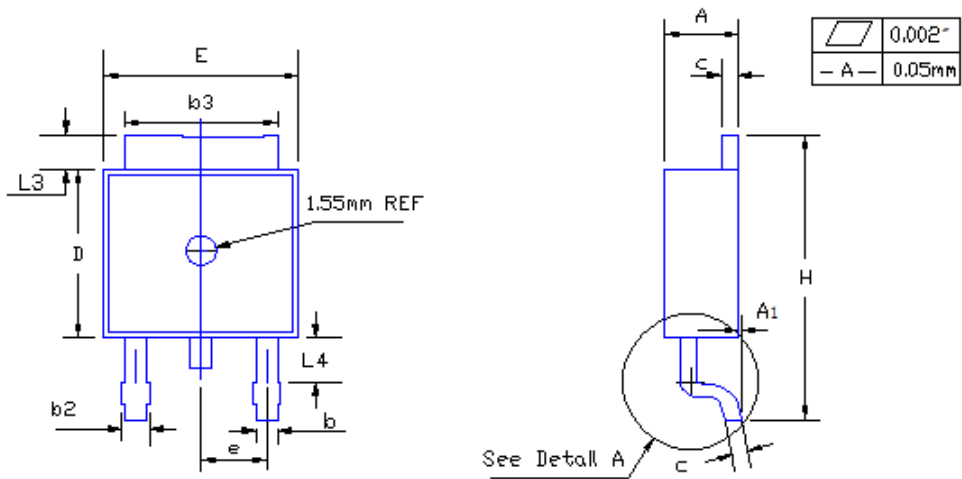

SYMBOL	MILLIMETERS	
	MIN	MAX
A	2.19	2.38
A1	—	0.13
b	0.64	0.89
b2	0.84	1.14
b3	5.21	5.46
c	0.46	0.61
D	5.97	6.22
D1	5.21	—
E	6.35	6.73
E1	4.83	—
e	2.29BSC	
H	9.65	10.41
L	1.40	1.78
L2	0.51BSC	
L3	0.89	1.27
L4	0.64	1.01
Ø	0	8

TO-251 (I-PAK) MECHANICAL DATA

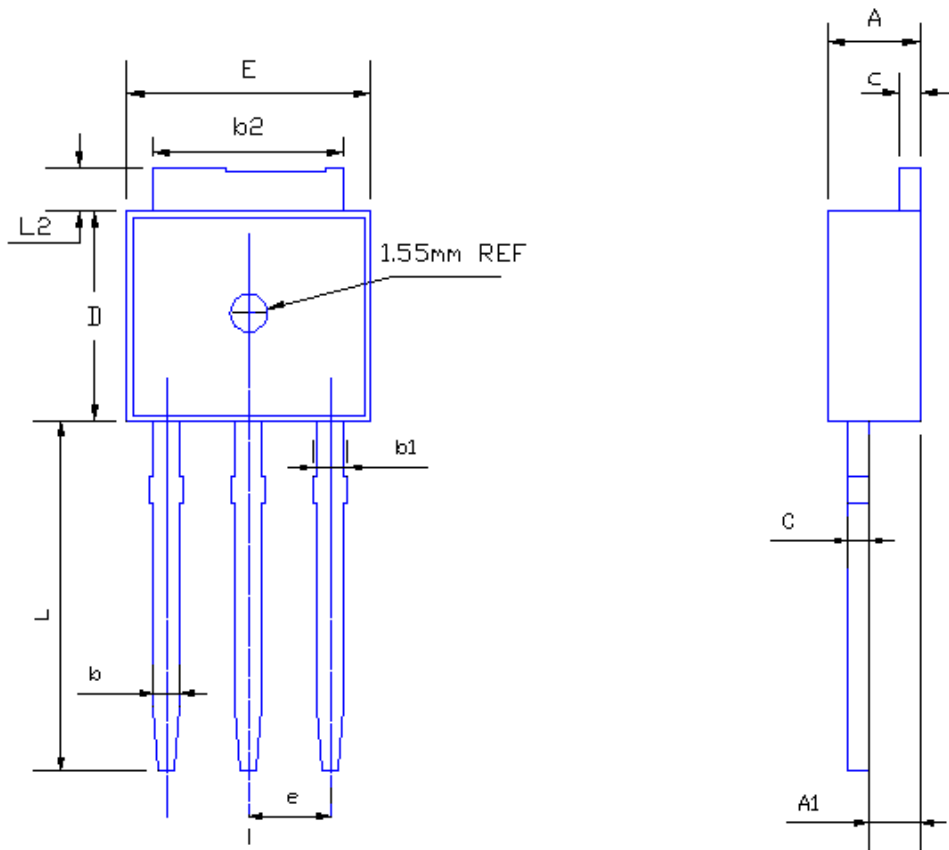

SYMBOL	MILLIMETERS	
	MIN	MAX
A	2.19	2.38
A1	1.04	1.23
b	0.64	0.89
b1	0.84	1.14
b2	5.23	5.48
c	0.46	0.61
D	5.91	6.28
E	6.21	6.59
e	2.28 TYP	
L	8.89	9.65
L2	0.89	1.27